

C845 Rivnut Hand Tool

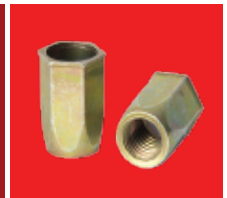

Rivnut: (one-piece) tubular rivet with internal threads; blind installation provides clean threads for screw attachments

www.cardinalcomponents.com
800-236-3200

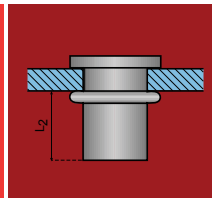
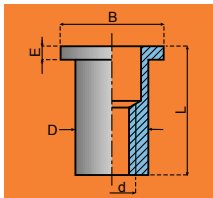
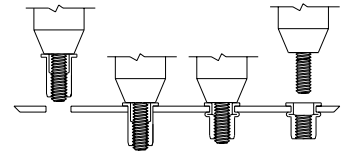

C845 Rivnut Hand Tool OPERATING INSTRUCTIONS

Lubricate 5/8" Jackscrew threads before use

Wrench Type Rivnut Fastener Headers are available for Rivnuts with the following thread sizes: 6-32, 8-32, 10-32, 10-24, 12-24, 1/4-20, 1/4-28 Metric sizes M3, M4, M5 & M6

1

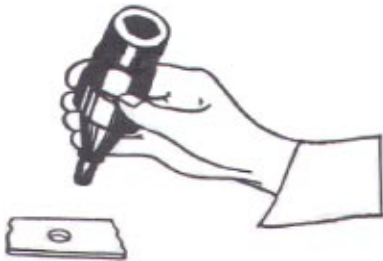

Engage all threads of the Rivnut Fastener on the pull up stud. Advance anvil until it is tight on head of Rivnut. Insert Rivnut in hole.

2

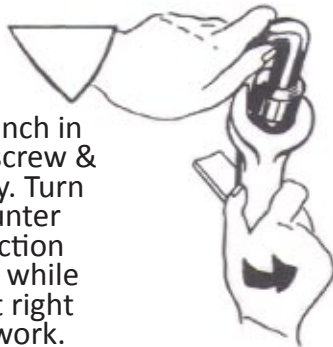

Place Hex Wrench in socket of jackscrew & hold stationary. Turn Hex Nut in counter clockwise direction with a wrench while holding tool at right angles to the work.

3

Turn nut the required number of turns - or until firm resistance indicates complete upset of the Rivnut. (a box end ratchet wrench will speed up this operation.)

Rivnut Thread	Approx. Turns Required to Upset	
	<u>in Min. Grip</u>	<u>in Max. Grip</u>
No. 6 & M3	1-1/4	1/2
No. 8 & M4	1-1/2	3/4
No. 10 & M5	1-3/4	1
No. 12	2	1-1/4
1/4" & M6	2-1/4	1-1/2

4

Break nut loose with clockwise movement. Remove both wrenches from the tool



5

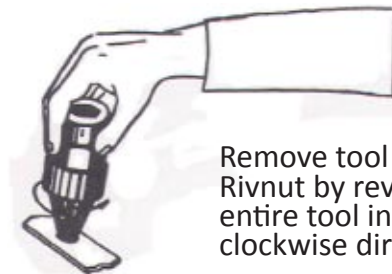

Remove tool from Rivnut by revolving entire tool in counter clockwise direction.

Call 800-236-3200
www.cardinalcomponents.com

W128 N8600 Old Orchard Rd., Menomonee Falls, WI 53051
ISO 9001:2008 Certified · info@cardinalcomponents.com
Visa, Mastercard & Discover Accepted · Fax: 262.252.5033