

C722 Rivnut Hand Tool

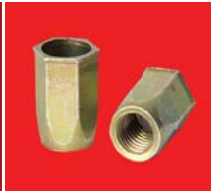
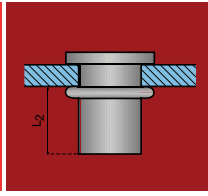
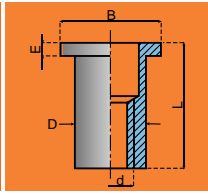
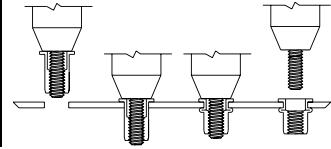

Rivnut: (one-piece) tubular rivet with internal threads; blind installation provides clean threads for screw attachments

www.cardinalcomponents.com
800-236-3200

C722 Rivnut Hand Tool OPERATING INSTRUCTIONS

Lubricate 1/2" Jackscrew threads before use

Wrench Type Rivnut Fastener Headers are available for Rivnuts & Plusnuts with the following thread sizes:
5/16 thru 1/2 Rivnuts, 5/16 thru 3/8 Plusnuts,
Metric M7 thru M12 Rivnuts, M8 thru M10 Plusnuts

1

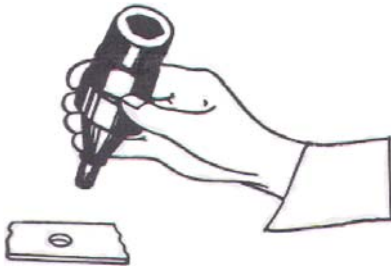

Engage all threads of the Rivnut Fastener on the pull up stud. Advance anvil until it is tight on head of Rivnut. Insert Rivnut in hole.

2

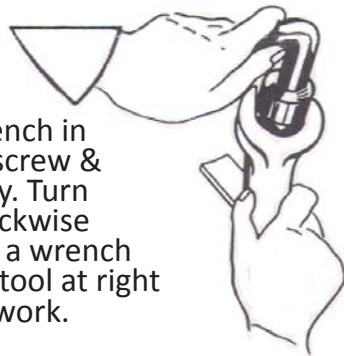

Place Hex Wrench in socket of jackscrew & hold stationary. Turn Hex Nut in clockwise direction with a wrench while holding tool at right angles to the work.

3

Turn nut the required number of turns - or until firm resistance indicates complete upset of the Rivnut. (a box end ratchet wrench will speed up this operation.)

Rivnut Thread	Approx. Turns Required to Upset	
	in Min. Grip	in Max. Grip
No. 6 & M3	1-1/4	1/2
No. 8 & M4	1-1/2	3/4
No. 10 & M5	1-3/4	1
No. 12	2	1-1/4
1/4" & M6	2-1/4	1-1/2

4

Break nut loose with clockwise movement. Remove both wrenches from the tool

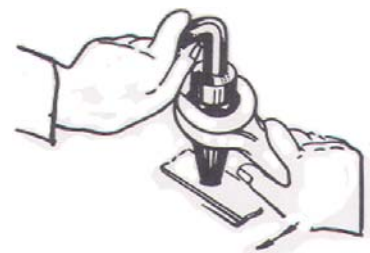

5

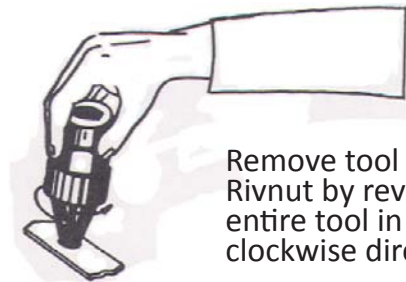

Remove tool from Rivnut by revolving entire tool in counter clockwise direction.

Call 800-236-3200
www.cardinalcomponents.com

W128 N8600 Old Orchard Rd., Menomonee Falls, WI 53051
ISO 9001:2000 Certified · info@cardinalcomponents.com
Visa, Mastercard & Discover Accepted · Fax: 262.252.5033